

CENTERLINE DIMENSIONS AND KEY PLAN OF COLUMN LAYOUT

NOTE:- 1) THE TOP B.C SOIL UP TO 1M. DEPTH SHALL BE COMPLETELY REMOVED AND FILL WITH GRAVEL / MURRUM AS PER STANDARD SPECIFICATION.

FOR NOTES AND SPECIFICATION REFER
DRAWING No. NC/STR/N4/2022(V)/GTTC- SINDHANOOR/GN&GD/01&01A

- GENERAL NOTES:-
"UNLESS OTHERWISE SPECIFIED"
- THIS STRUCTURAL DRAWINGS SHALL BE READ IN CONJUNCTION WITH RELEVANT LATEST ARCHITECTURAL AND OTHER MEP DRAWINGS. ANY DISCREPANCY SHALL BE CLARIFIED BEFORE EXECUTION.
- ALL DIMENSIONS ARE IN MILLIMETERS.
 - ALL LEVELS ARE IN METERS.
 - COLUMNS AND FOUNDATIONS ARE DESIGNED FOR GROUND + 4UPPER FLOORS + HEAD ROOM ONLY.
 - S.B.C. CONSIDERED IN THE DESIGN AS PER REPORT IS 150 KN/M² AT 2400MM DEPTH.
 - FOUNDATION SHALL BE LAID ON FIRM SOIL.
 - BOTTOM OF EXCAVATION FOR FOOTINGS SHALL BE AT A LEVEL WHICH IS LOWEST OF THE FOLLOWING:-
 - 2400MM BELOW THE GENERAL FLOOR LEVEL.
 - FLOORING MARGIN + FOOTING DEPTH 'D'+ WATER PROOFING + 75MM PCC BELOW FLOOR LEVEL.
 - BELOW DEPTHS REQUIRED FROM SERVICES CRITERIAS SUCH AS SUMP TANK BOTTOMS, INVERT LEVELS, ETC.
 - LEVEL DIFFERENCE BETWEEN ANY TWO FOOTING BASE SHALL NOT BE MORE THAN DISTANCE BETWEEN THE TWO ADJACENT EDGES -450mm.
- FOOTING AT LOWER LEVEL
- FOOTING AT HIGHER LEVEL
- MIN. 'X'
- 'X'-450
- LIFT FOOTING & FOOTINGS AROUND LIFT SHALL BE LOWERED AS PER LIFT MANUFACTURERS REQUIREMENT
 - CONCRETE MIX. SHALL BE M25 FOR FOOTINGS, M25 FOR LIFT WALLS AND COLUMNS
 - STEEL GRADE SHALL BE : Fe550D.

- CLEAR COVER TO MAIN REINFORCEMENT SHALL BE,
 - (A) FOOTINGS AND FOUNDATION BEAMS
 - (B) IN COLUMNS WITH WIDTH UPTO 200mm SHALL BE 25mm
 - (C) IN COLUMNS WITH WIDTH > 200mm SHALL BE 40mm
 - (D) RC WALLS 25mm
 - (E) RETAINING WALL: ON EARTH FACE 50mm, ON OTHER FACES 25mm
- LAP LENGTH SHALL BE L_d.
- WHERE d IS THE SMALLER DIAMETER OF THE BAR
- COLUMN LINKS SHALL BE @225/250 REFER COLUMN SCHEDULE.
- INSIDE & OUTSIDE FILLING SHALL BE CARRIED OUT SIMULTANEOUSLY.
- CONCRETE SHALL BE OF MIX M25 AS DEFINED IN IS-456:2000 WITH 20mm DOWNSIZE AGGREGATES IN ALL STRUCTURAL MEMBERS.
- ADMITURES SHALL BE USED ONLY AFTER WRITTEN CONFIRMATION BY CONCERN AUTHORITY OR CONSULTANT.
- ALL CONSTRUCTION JOINTS SHALL BE FORMED AT RIGHT ANGLE TO THE MAIN REINFORCEMENT.
- TOLERANCES IN DIMENSIONS, LEVELS SHALL BE IN ACCORDANCE WITH IS 456.
- SAMPLES FROM FRESH CONCRETE SHALL BE TAKEN AS PER IS 1199 AND CUBES SHALL BE MADE, CURED AND TESTED AS PER IS 516.
- HIGH YIELD STRENGTH DEFORMED BARS SHALL CONFORM TO IS 1786.
- HOT ROLLED DEFORMED BARS CONFORM TO IS 1139.
- ALL STEEL REINFORCEMENT SHALL BE FABRICATED AND FIXED IN ACCORDANCE WITH IS 2502,SP-34.
- ADEQUATE CHAIRS AND PINS RODS SHALL BE USED TO KEEP THE REINFORCEMENT IN ITS POSITION.
- SEQUENCE OF DESHUTTERING SHALL BE APPROVED BY PROJECT MANAGER OR CONSULTANTS AND SHALL BE IN SEQUENCE OF CONCRETING.
- LEVELS SUBJECTED TO ARCHITECTS/CE & APPROVAL.

- NOTE:
- GRADE OF CONCRETE FOR FOOTINGS-M25
 - GRADE OF CONCRETE FOR COLUMN & PEDESTAL-M25
 - GRADE OF STEEL-Fe550D
 - CLEAR COVER FOR COLUMNS -40MM
 - CLEAR COVER FOR FOOTINGS -50MM

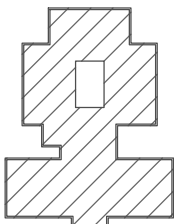

KEY PLAN :

VERIFIED BY

DY. MANAGER-PROJECT
GT&TC

MANAGER-PROJECT
GT&TC

CLIENT :



GOVT. TOOL ROOM AND TRAINING CENTRE
RAJAJINAGAR INDUSTRIAL ESTATE,
BANGALORE-560010

PROJECT:

ESTABLISHMENT OF NEW GTTC CENTRE AT SINDHANOOR
IN RAICHUR DISTRICT.

CONSULTANTS:

NC NAVEEN CONSULTANTS
ARCHITECTS & ENGINEERING CONSULTANTS
#1308,2nd floor,2nd Cross,Ashoka Nagara
(Behind B.M.S Engineering College Hostel)
Bangalore : 560050.
Ph:080-26620836(a) Fax:26620836
Email:- naveenconsultants@gmail.com,
naveenconsultants1@gmail.com

TITLE:

STAFF QUARTERS & GIRLS HOSTEL

DRAWING:

CENTERLINE DIMENSIONS AND KEY
PLAN OF COLUMN LAYOUT

DRAWN BY : GSR

DATE : 14/10/2025

DESIGN BY : MEP

SCALE : NTS

CHECKED BY: KVNS

SHEET : A2

DWG NO:

SQ & GH -01

RELEASED FOR: Preliminary Drawing Tender Information Only For Approval For Construction